

Section 560 SO 423274

Ngati Parekawa Dr

RT 663427

WHAREROA ESPLANADE RESERVE

Lot 500 DPS 46631  
Local Purpose Reserve

LAKE

Lot 1 DPS 25579

**NOTES:**

1. CONTRACTOR TO DIAL BEFORE YOU DIG.
2. ALL DIMENSIONS IN MILLIMETRES UNLESS OTHERWISE STATE. ALL DIMENSIONS TO BE CHECKED & CONFIRMED ON SITE.
3. REFER STRUCTURAL & CIVIL REQUIREMENTS FOR GROUND PREPARATION & IMPROVEMENT BEFORE COMMENCING WORKS.
4. ALL BELOW GROUND ASSETS TO BE IDENTIFIED PRIOR TO COMMENCING WORKS.
5. LOCATION OF BELOW GROUND ASSETS ARE INDICATIVE ONLY. BELOW GROUND PIPEWORK AND ELECTRICAL CABLES NOT SHOWN.
6. PIPEWORK CONNECTIONS INTO THE BUILDING ARE TO BE PROVIDED BY THE CIVIL AND BUILDING CONTRACTOR.
7. TREATMENT PLANT TO BE FENCED.
8. EXISTING TELEMETRY SYSTEM TO BE KEPT.
9. BORES TO BE LIFT ABOVE GROUND. A NEW SLAB & SECURITY FENCING TO BE BUILT. FENCED AREA TO BE APPROXIMATELY 5m LONG & 2m WIDE.

**PROPERTY INFORMATION:**

EXISTING BUILDING FLOOR AREAS = 16.0m<sup>2</sup>  
 NEW CONTAINER FLOOR AREA = 32.0m<sup>2</sup>  
 TOTAL FLOOR AREA = 48.0m<sup>2</sup>

**OPTION 1:**

- \* EXISTING BUILDING TO BE EXTENDED TO ALLOW FOR THE NEW TREATMENT PLANT EQUIPMENT.
- \* BORE PIPE WORK TO BE DIVERTED TO THE NEW EQUIPMENT, THROUGH TREATMENT AND INTO THE CHLORINE CONTACT TANK.
- \* OVERFLOWED TREATED WATER TO BE HYDRAULICALLY LINKED TO THE PUMP TANK.
- \* TREATED WATER TO BE PUMPED UP TO THE SYSTEM WITH LEVEL CONTROLLED BY THE HIGH LEVEL RESERVOIR.
- \* BELOW GROUND PIPE WORK TO BE RELOCATED TO ALLOW FOR NEW SYSTEM AND EQUIPMENT.

**BUILDING MATERIALS:**

- \* EXTERNAL CLADDING TO MATCH EXISTING BUILDING, BOARD AND BATTEN.
- \* ROOFING MATERIALS TO MATCH EXISTING BUILDING, CORRUGATED IRON.

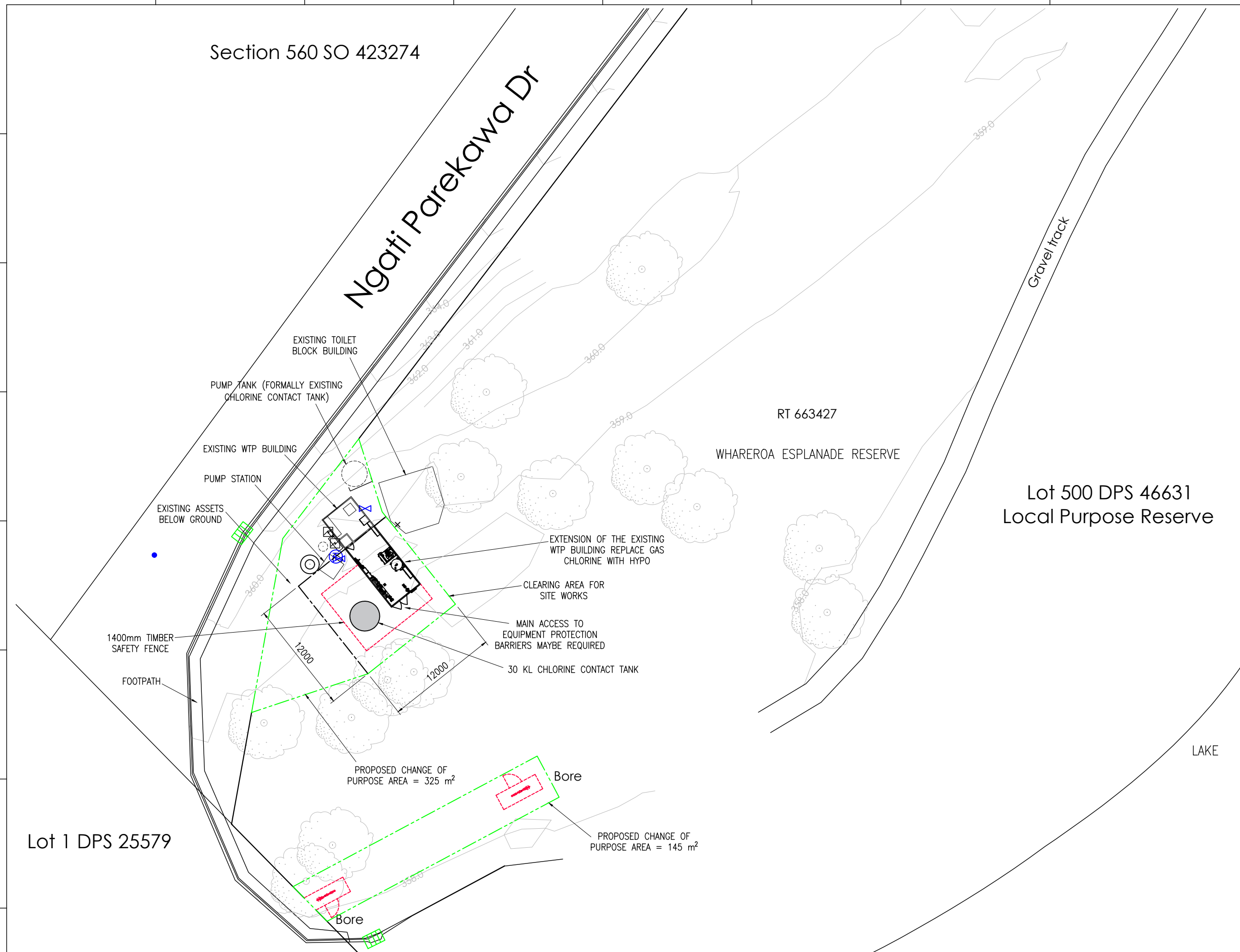

REV	AMENDMENT	BY	DATE	CHKD	APP	OTHER	DATE
A	ISSUED FOR COMMENTS TO TDC & CONTRACTORS	JWU	27/05/21	-	-		03/21
B	CORRECT TREATMENT BUILDING ADDED	JWU	14/09/21	RPK	-		07/04/21
C	LAYOUT MODIFIED AND AREA MORE DEFINED	RPK	01/03/22	-	-		03/21
D	LAWYERS COMMENTS INCORPORATED	JWU	01/04/22	RPK	-		-

SCALE: 1:200

AKO Engineers Limited  
 Cambridge 3434  
 New Zealand  
 Web: akoengineers.co.nz

GREAT LAKE TAUPŌ  
 Taupō District Council

AKO ENGINEERS

WHAREROA WTP  
 WATER SUPPLY  
 SITE PLAN - OPTION 1

CLIENT: TAUPŌ DISTRICT COUNCIL	REV
CLIENT DRG. No. -	D
DRAWING NUMBER: 159-2004-DG610_1	

Section 560 SO 423274

Ngati Parekawa Dr

RT 663427

WHAREROA ESPLANADE RESERVE

Lot 500 DPS 46631  
Local Purpose Reserve

Lot 1 DPS 25579

LAKE

Gravel track

**NOTES:**

1. CONTRACTOR TO DIAL BEFORE YOU DIG.
2. ALL DIMENSIONS IN MILLIMETRES UNLESS OTHERWISE STATE. ALL DIMENSIONS TO BE CHECKED & CONFIRMED ON SITE.
3. REFER STRUCTURAL & CIVIL REQUIREMENTS FOR GROUND PREPARATION & IMPROVEMENT BEFORE COMMENCING WORKS.
4. ALL BELOW GROUND ASSETS TO BE IDENTIFIED PRIOR TO COMMENCING WORKS.
5. LOCATION OF BELOW GROUND ASSETS ARE INDICATIVE ONLY. BELOW GROUND PIPEWORK AND ELECTRICAL CABLES NOT SHOWN.
6. PIPEWORK CONNECTIONS INTO THE NEW BUILDING AREA TO BE PROVIDED BY THE TECHNOLOGY SUPPLIER.
7. TREATMENT PLANT TO BE FENCED.
8. EXISTING TELEMETRY SYSTEM TO BE KEPT.
9. SOME TREES TO BE PRUNED BACK TO SUIT.
10. BORES TO BE LIFTED ABOVE GROUND. A NEW SLAB & SECURITY FENCING TO BE BUILT. FENCED AREA TO BE APPROXIMATELY 5m LONG & 2m WIDE.

**PROPERTY INFORMATION:**

EXISTING BUILDING FLOOR AREAS	= 16.0m <sup>2</sup>
NEW CONTAINER FLOOR AREA	= 24.0m <sup>2</sup>
TOTAL FLOOR AREA	= 40.0m <sup>2</sup>

**OPTION 2:**

- \* NEW BUILDING WITH TREATMENT PLANT TO BE PLACED ON A NEW EARTH PAD.
- \* BORE PIPE WORK TO BE DIVERTED TO THE NEW BUILDING, THROUGH TREATMENT AND INTO THE CHLORINE CONTACT TANK.
- \* OVERFLOWED TREATED WATER TO BE HYDRAULICALLY LINKED TO THE PUMP TANK.
- \* TREATED WATER TO BE PUMPED UP TO THE SYSTEM WITH LEVEL CONTROLLED BY THE HIGH LEVEL RESERVOIR.

**BUILDING MATERIALS:**

- \* COLOUR STEEL FLAT PANEL WALLS & ROOF.

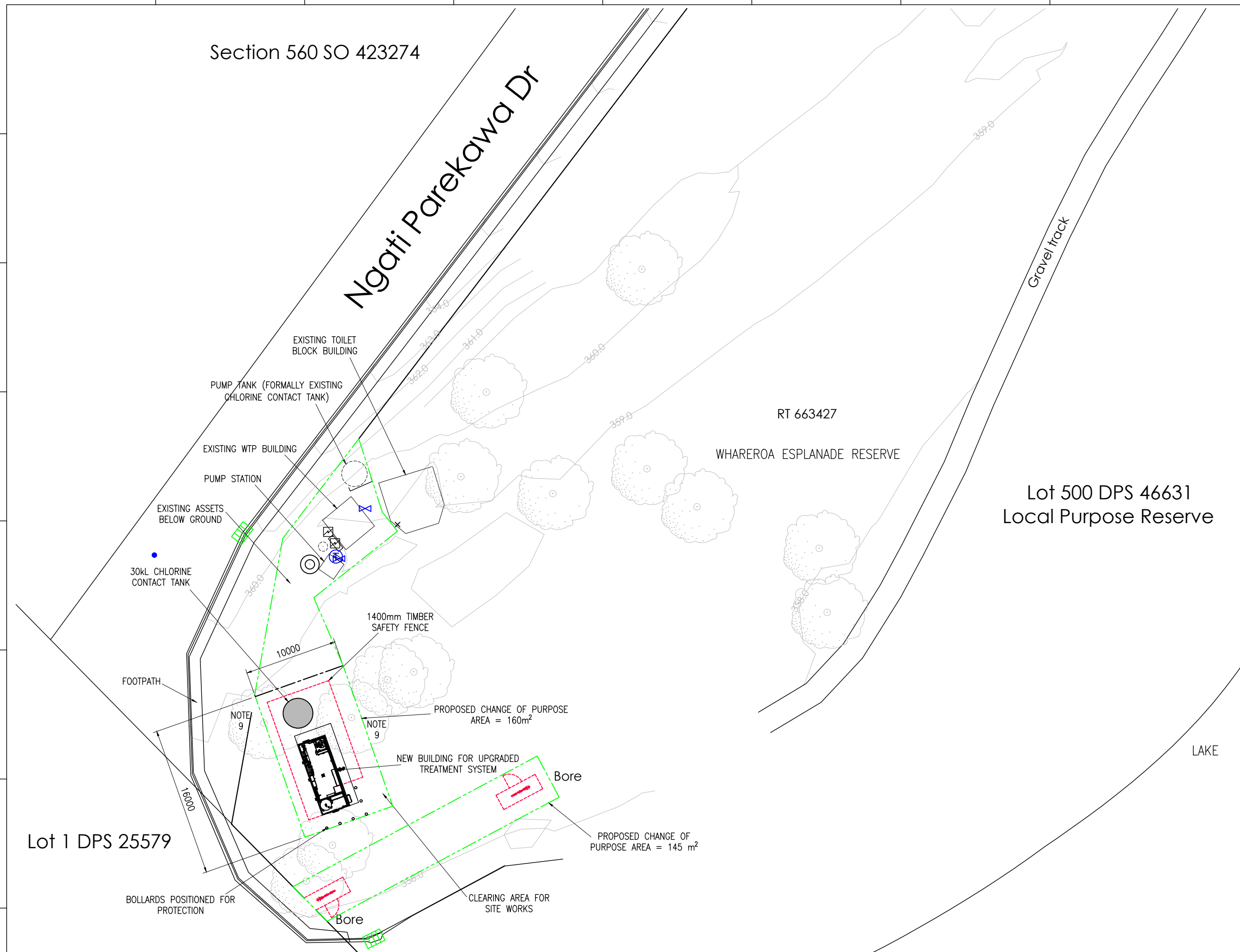

REV	AMENDMENT	BY	DATE	CHKD	APP	OTHER	DATE
A	ISSUED FOR COMMENTS TO TDC & CONTRACTORS	JWU	27/05/21	-	-		03/21
B	LAYOUT MODIFIED AND AREA MORE DEFINED	RPK	01/03/22	-	-		07/04/21
C	LAWYERS COMMENTS INCORPORATED	JWU	01/04/22	RPK	-		03/21
APPROVED: -							-
SCALE: 1:200							



AKO Engineers Limited  
Cambridge 3434  
New Zealand  
Web: akoengineers.co.nz

WHAREROA WTP  
WATER SUPPLY  
SITE PLAN - OPTION 2

CLIENT: TAUPŌ DISTRICT COUNCIL	REV
CLIENT DRG. No. -	C
DRAWING NUMBER: 159-2004-DG610_2	