

FACT SHEET – Finished Ground

Finished Ground and/or paving levels are specified in both the Building Code (Clause E2) and NZS 3604:2011.

The Building Code recommends that the building platform be formed at a level of at least 300mm below the finished floor level with the exterior ground sloped to carry water away from the exterior walls. This allows landscaping and paving to be built up while still maintaining the required clearances.

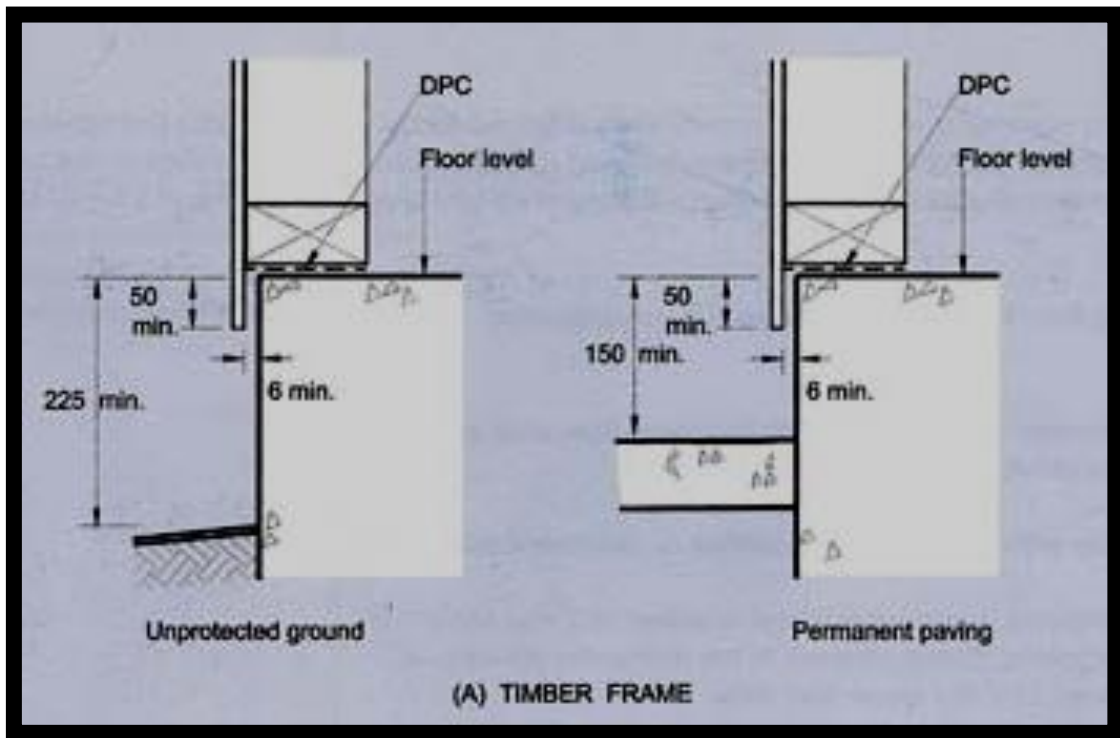

By following examples shown from NZS 3604:2011 Fig 7.11 compliance with the Building Code is established.

Options for reduced ground clearances are available in the New Zealand Building Code E1 AS1, Fig 17b.

This information is available on the Department of Building and Housing website www.dbh.govt.nz (compliance documents).

The New Zealand Building Code clause E2 requires a differential of 50mm between any garage floor and paved driveway when following the acceptable solution.

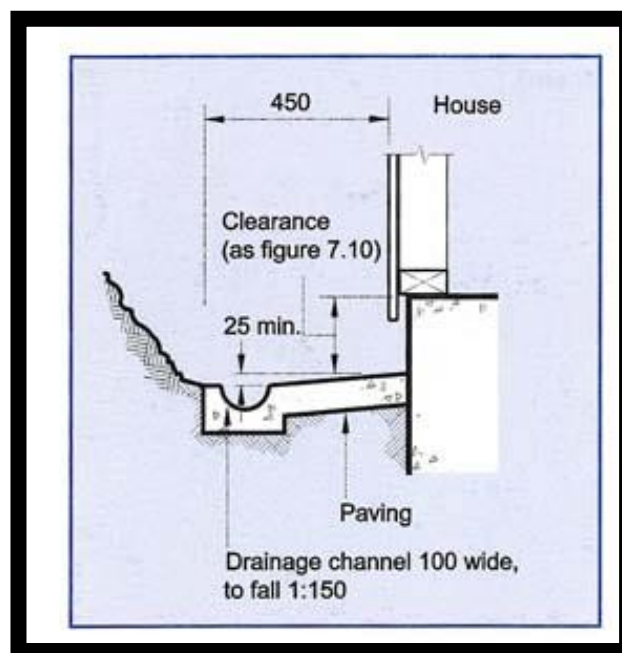
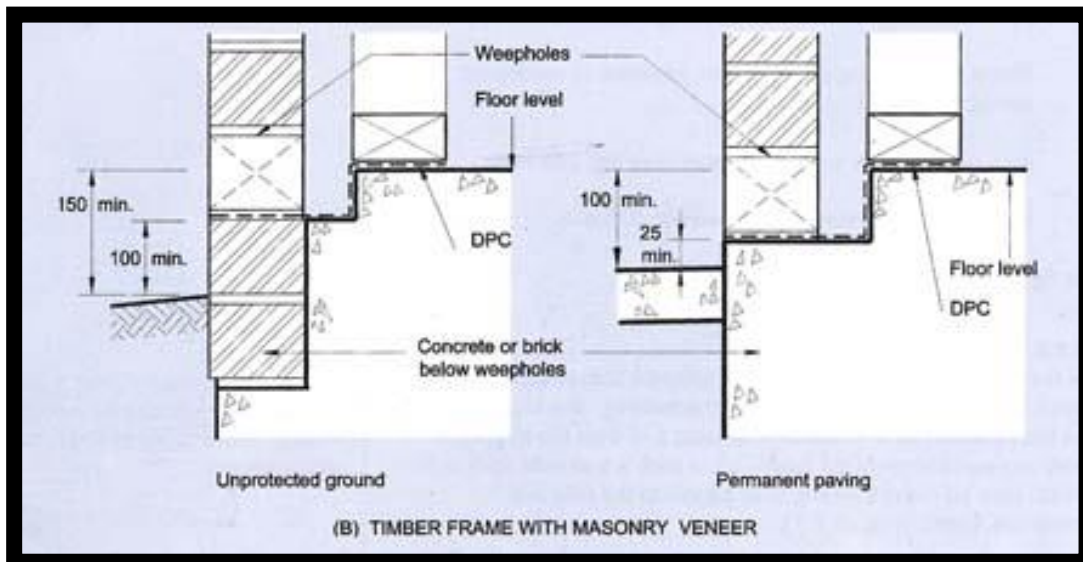

Where these ground clearances are not complied with the manufacturers of numerous products will not provide a warranty.

Without meeting these levels a building may not comply with the Building Code, which would stop Council from issuing a Code Compliance Certificate.