

Designed	Checked	Approved	Date
TMB			09/02/24

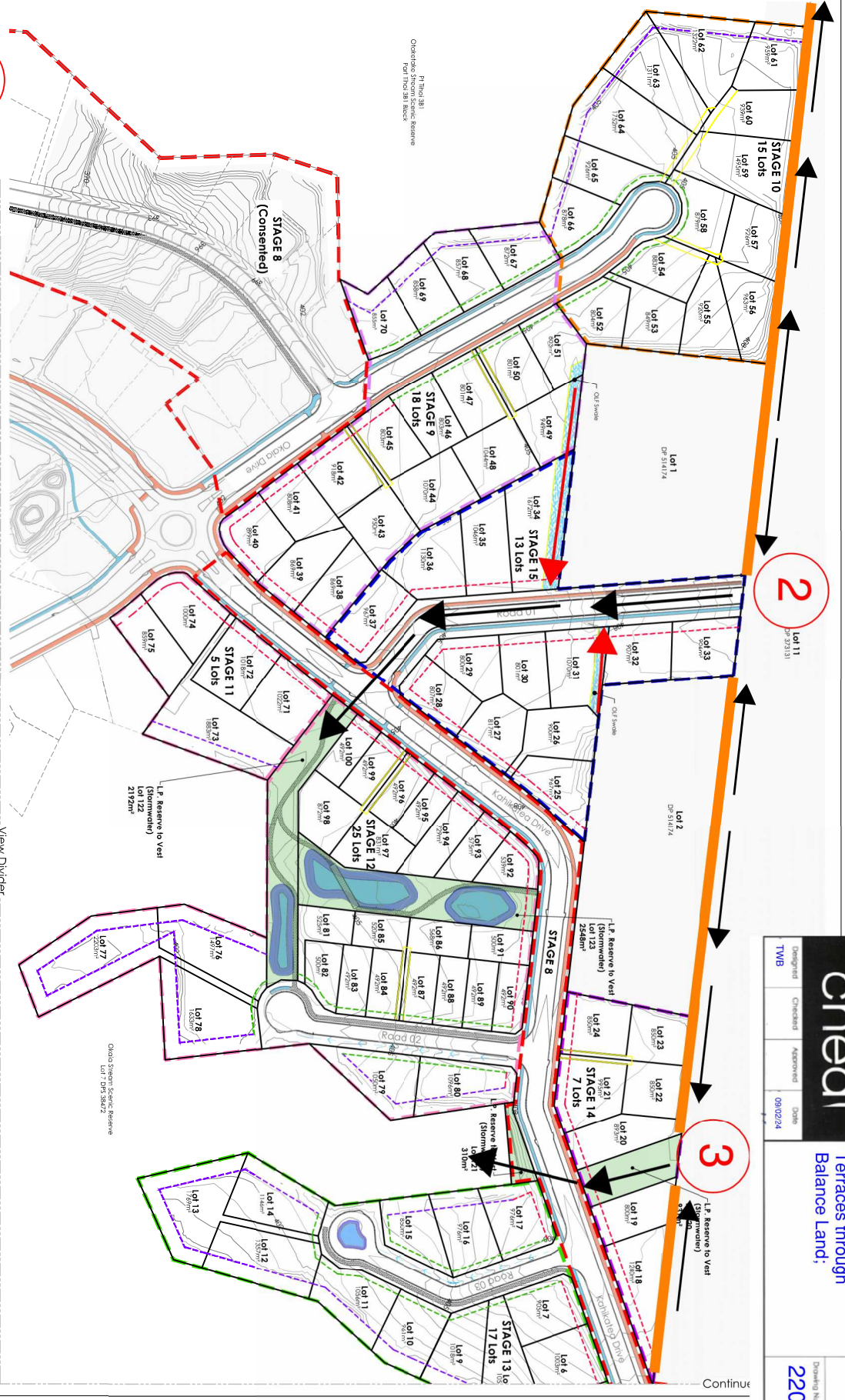

- 1
- 2
- 3

Overland Flows from the Terraces diverted into Balance Land Road 01 and then through Stormwater Reserve to existing discharge point in adjacent Department of Conservation Land to Okaiia Stream.

Overland Flows from the Terraces diverted into Stormwater Reserve between Lots 19 and 20, under Kahikatea Drive to existing discharge point in adjacent Department of Conservation Land to Okaiia Stream.

- 1
- 2
- 3

Diversion Bunds/Swales between Terraces and Balance Land

Diversion Channels at southern downstream edge of Lot 1 and at southwest corner of existing Lot 2 to divert overland flows to Road 01.